

A man in a white Ansell AlphaTec 1800 Standard coverall and safety glasses is working in a blue industrial setting. The coverall has a green label on the chest that reads "AlphaTec 1800 STANDARD". The background features a large blue machine with the text "Leistritz LWN 160" visible.

**Ansell**

# INDUSTRY GUIDE

MACHINERY & EQUIPMENT





## MACHINERY & EQUIPMENT INDUSTRY PROCESSES



### 1. PRESS SHOP

#### Applications:

- Seizing structural and body parts
- Inspection
- Feed the press and remove spare parts from it

#### User needs:

- High abrasion resistance
- Medium to high cut protection
- Dry or oil grip



HyFlex® 11-937



HyFlex® 11-735



HyFlex® 11-927



RINGERS R-065



### 2. BODY SHOP

#### Applications:

- Seizing structural and body parts
- Assembling big parts together by welding
- Riveting

#### User needs:

- Medium to high cut protection
- Dry or oil grip
- Medium to high dexterity



HyFlex® 11-738



HyFlex® 11-927



ActivArm® 43-216



### 3. MACHINING

#### Applications:

- Seizing rough blocks and cylinders
- Assembling and mounting components
- Inspection in each circumstance

#### User needs:

- Medium to high cut resistance
- Dry or oil grip
- Oil repellence



HyFlex® 11-724



AlphaTec® 1600 PLUS  
(ex. MICROGARD®)



### 4. MOLDING

#### Applications:

- Seizing and finishing structural parts
- Inspection in each circumstance

#### User needs:

- High abrasion resistance
- High cut resistance
- Contact heat resistance (80 to 100°C)



ActivArm® 80-813  
(ex. Powerflex®)



HyFlex® 11-550



HyFlex® 70-225\*  
(ex. Neptune® Kevlar®)



### 5. PAINT SHOP

#### Applications:

- Body surface checking, marking and touching up
- Applying sealer on body
- Painting or cleaning tools or robots

#### User needs:

- Paint-compatible gloves
- Ability to feel surface for abrasion
- Chemical resistance (painting/cleaning)



AlphaTec® 58-735



AlphaTec® 1800 COMFORT\*  
(ex. MICROGARD®)



MICROFLEX® 93-260



### 6. FINAL ASSEMBLY

#### Applications:

- Seizing structural parts
- Adjusting systems and screwing using wrenches
- Fixing, clipping parts and wire harnesses

#### User needs:

- High abrasion
- Low to medium cut protection
- Medium range dry and oil grip



HyFlex® 11-518



HyFlex® 11-816



HyFlex® 11-840



RINGERS R-133



RINGERS R-138



### 7. LOGISTICS

#### Applications:

- Loading and unloading rough parts or boxes
- Cutting cardboard, picking parts and accessories
- Driving vehicles

#### User needs:

- Dry, wet or oily grip
- High dexterity
- Cold weather protection



HyFlex® 11-518



HyFlex® 11-840



ActivArm® 97-012



RINGERS R-161



### 8. MAINTENANCE

#### Applications:

- Mounting and dismantling
- Changing tools and dies
- Welding

#### User needs:

- Mechanical, chemical, thermal and electrical protection
- High dexterity and tactility



HyFlex® 11-840



E013Y Class 00  
11" Yellow



HyFlex® 11-939



HyFlex® 11-816

\*There will be a transitional period where there will be a mix of old and newly branded products in the market. Functionality and performance of the products will remain unchanged, the current products and the new ones have the same quality and same protection.



## GET MORE PRODUCT INFORMATION ONLINE

Our new website provides content rich of information on safety, solutions, documents and downloads, regulatory and company information with simple navigation of our full portfolio of hand, arm and body protection solutions.

➔ [www.ansell.com/industrial](http://www.ansell.com/industrial)

## PRODUCT INFORMATION



Your search options also include various downloadable data sheets:

- A** Product sheets
- B** EU declarations conformity
- C** Instructions for use
- D** Food declarations of product conformity

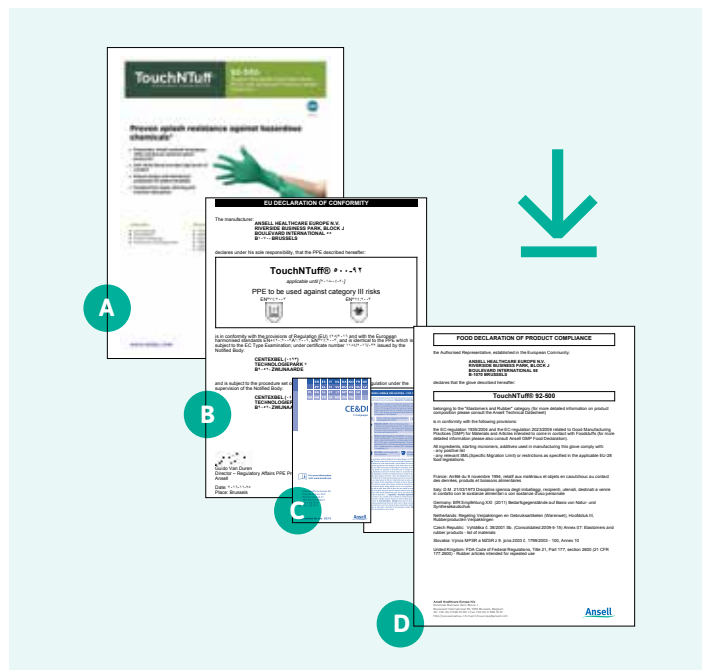

## INDUSTRIAL SECTION

Explore the new search and navigation features for a seamless web experience:

### 1 Ansell Solutions by type of protection



### 2 News & Campaigns



### 3 Newsletters: Safety Briefing



### 4 Ansell Solutions by Industries



**FOR FURTHER INFORMATION OR TO REQUEST A SAMPLE, CONTACT YOUR SALES REPRESENTATIVE.**